



# SMD GEARBOX

## SMD

BRILLIANTLY AGILE!



# HIGH PRECISION SERVO GEARBOX



ROTATING FLANGE OUTPUT

# SNDU Series

Planetary Gearbox  
with Square Mounting Flange



## SNDU 60

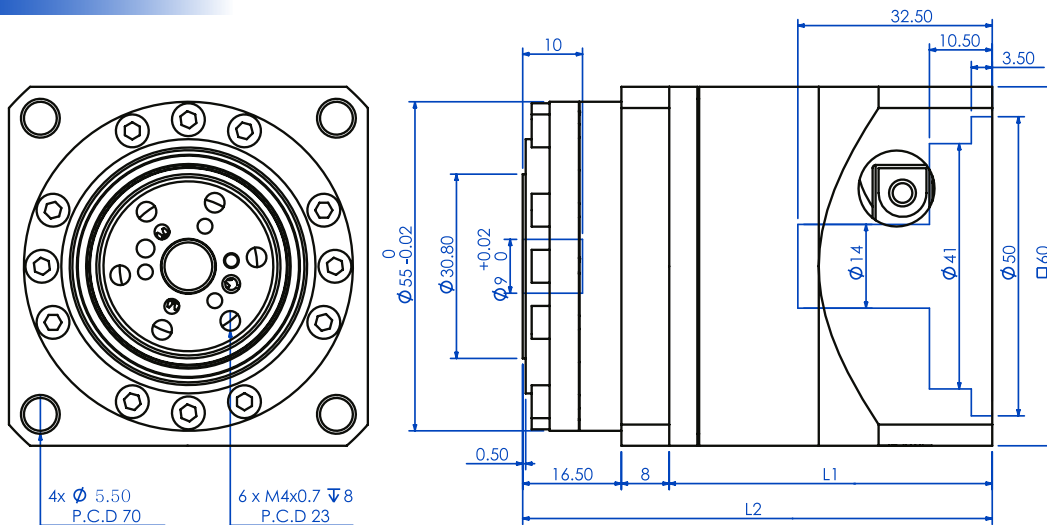

- L1 L1=54  
L2=74  
L3=94
- L2 L1=78.5  
L2=98.5  
L3=118.5

## SNDU 90

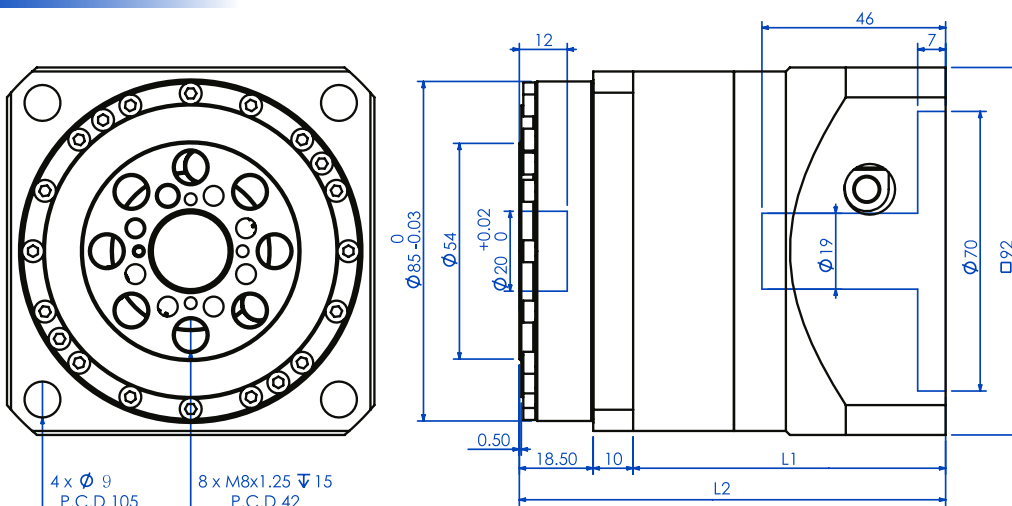

- L1 L1=78.25  
L2=117.25  
L3=156.75
- L2 L1=106.75  
L2=146.25  
L3=185.75

## SNDU 120

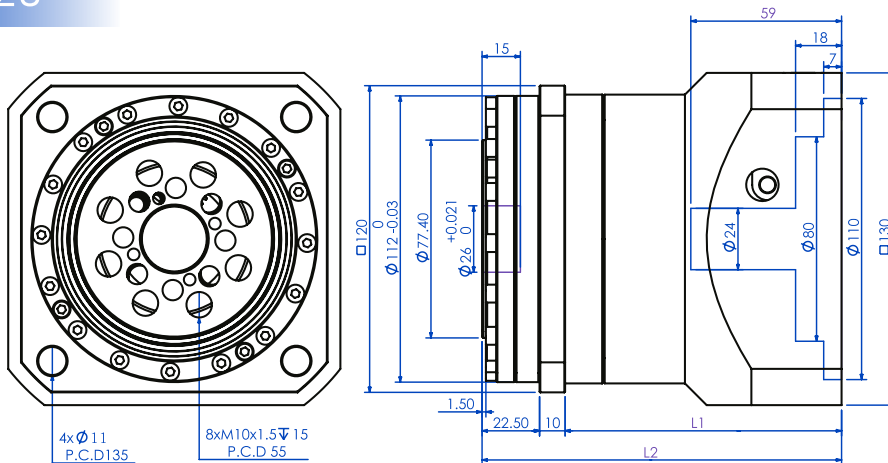

L1 = 108.2  
L2 = 137.25  
L3 = 176.8

L1 = 140.7  
L2 = 169.75  
L3 = 209

## SNDU 150

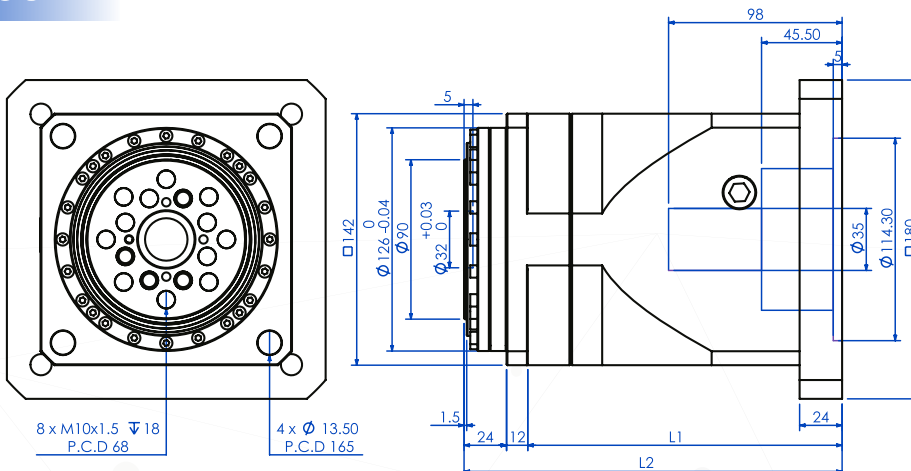

L1 = 177.5  
L2 = 191.7  
L3 = 231.25

L1 = 213.5  
L2 = 227.7  
L3 = 267.25

## FEATURES:

- Flange Style output.
- Output housing is Aluminum.
- Suitable for combination with any kind of Servo Motors.
- Total enclosed design and Easy to install.
- High rating torque and low inertia.
- Sealed shut design, Self-lubricated.
- The design of Flange output is suitable for high and equal load distribution and has taping for mounting applications.

Performances	Unit	Stages	Ratio	SNDU60	SNDU90	SNDU120	SNDU150
<b>Nominal Output Torque</b>	Kgf*m/Nm	1	3	2.7/26.4	9/88.2	18.2/178.3	35.7/349.8
			4	2.9/28.4	9.2/90.1	18.9/185.2	37.1/363.5
			5	3/29.4	36069	21/205.8	38.5/377.3
			7	2.8/27.4	9.1/89.1	11.2/109.7	35/343
			9	N/A	N/A	17.5/171.5	N/A
			10	2.6/25.4	8.8/86.2	10.5/102.9	34.3/336.1
		2	9	2.7/26.4	9/88.2	N/A	35.7/349.8
			12	2.7/26.4	9/88.2	18.2/178.3	35.7/349.8
			15	2.7/26.4	9/88.2	18.2/178.3	35.7/349.8
			16	2.9/28.4	9.2/90.1	18.9/185.2	37.1/363.5
			20	2.9/28.4	9.2/90.1	18.9/185.2	37.1/363.5
			21	2.7/26.4	9/88.2	18.2/178.3	35.7/349.8
			25	3/29.4	36069	21/205.8	38.5/377.3
			28	2.9/28.4	9.2/90.1	18.9/185.2	37.1/363.5
			30	2.7/26.4	9/88.2	18.2/178.3	35.7/349.8
			35	3/29.4	36069	21/205.8	38.5/377.3
			40	2.9/28.4	9.2/90.1	18.9/185.2	37.1/363.5
			49	2.8/27.4	9.1/89.1	11.2/109.7	35/343
			50	3/29.4	36069	21/205.8	38.5/377.3
70	2.8/27.4	9.1/89.1	11.2/109.7	35/343			
100	2.6/25.4	8.8/86.2	10.5/102.9	34.3/336.1			
<b>Max Acceleration Torque</b>	Kgf*m/Nm	1,2	3~100	3 Times Nominal Output Torque			
<b>Emergency Stop Torque</b>	Kgf*m/Nm	1,2	3~100	3.4 Times Nominal Output Torque			
<b>Permissible Input Speed</b>	rpm	1,2	3~100	1000			
<b>Reduced Backlash</b>	Arc-min	1	3~10	<1	<1	<1	<1
		2	9~100	1	1	1	1
<b>Max Tilting Moment</b>	Kgf*m/Nm	1,2	3~100	3.75/36.75	13.7/134.26	27.48/269.3	37.38/366.3
<b>Max. Radial Force</b>	Kgf/N	1,2	3~100	214/2097	442/4331	687/6732	779/7634
<b>Max. Axial Force</b>	Kgf/N	1,2	3~100	107/1048	221/2165	343.5/3366	389.5/3817
<b>Rated life</b>	Hr	1,2	3~100	> 10,000			
<b>Operating Temperature Range</b>	°C	12	3~100	-10°C to +40°C ambient --90°C max operating case temperature			
<b>Sound Level</b>	dB (A)	1	3~100	63	66	68	70
		2	9~100	63	66	66	68
<b>Lubrication</b>	-	1,2	3~100	Lubricated for life (Synthetic Grease)			
<b>Protection Class</b>	-	1,2	3~100	IP54			
<b>Gearhead Inertia</b>	Kg*cm2	1	3~10	0.127	1.247	2.274	10.19
		2	9~100	0.127	1.247	1.247	10.19
<b>Efficiency At Full Load Rated</b>	%	1,2	3~100	Stage one 95% ; Stage two 90%			
<b>Weight</b>	Kg	1	3~10	0.8	3	6.4	13
		2	9~100	1.1	4.1	8.4	16
<b>No-load Running Torque</b>	Kgf*m/Nm	1	3~10	3/0.3	6.1/0.6	12/1.2	14.8/1.45
		2	9~100	0.3/3	0.6/6.1	1.2/12	1.45/14.8

**Note:** Above mention Dimensions are for standard motor sizes, for other Dimensions, motor mountings adapter plate / mounting will be attached.



# SMD

BRILLIANTLY AGILE!

## GET IN TOUCH

### HEADQUARTERS

**SMD** Gearbox (Taiwan)

 Zhongshan Rd, Taichung City,  
Taiwan - 41171.

 +886 933510083

[sales@smdgearbox.com](mailto:sales@smdgearbox.com)

### HEAD OFFICE (OVERSEAS)

**SMD** Gearbox (India)

 A-51, H Block, M. I. D. C., Pimpri-Chinchwad  
Pune, Maharashtra, India - 411018.

 +91 70306 69818

 +91 020-46212730

[www.smdgearbox.com](http://www.smdgearbox.com)

